



Outside Dimensions by Frame Style Size

Specifications

Specifications

Specifications						Group 1 1 1/4" Frame	Group 2 1 1/2" Frame	Group 3 1 5/8" Frame	Group 4 2" Frame	Group 5 2 1/8" Frame	Group 6 2 3/8" Frame	Group 7 2 1/2" Frame	Group 8 2 3/4" Frame	Group 9 3 1/4" Frame
Product Code	Approx. Overall Dimen. (WxH)	Recessed Rough Wall Opening	Depth Of Cabinet	Mirror Door Sizes (M=Middle Door)	Number Of Glass Shelves	Brushed Satin (SAT) Soho (SOH)	Aristocrat (ARS) Colorgrain (COL)	Arlington (ARL) Majestic (MAJ) Rustic Wood (RUS) Tuscany (TUS) Valencia (VAL)	Jewel Cut Bevel (JCB) Meridian (MER) Parliament (PAL) Roman (ROM) Tribeca (TRI)	Chateau (CHA) Parisian (PAR)	Sienna (SIE)	Versailles (VER)	Elegance (ELG)	Regal (REG)
Single Door w/ 3/4" Bevel Mirror														
SD .	17"x 26"	14 3/8" x 23"	4 3/8"	13 1/4" x 21 3/8"	3	16" x 24 1/2"	16 1/2" x 25"	16 3/4" x 25 1/4"	17 1/2" x 26"	17 3/4" x 26 1/4"	18 1/4" x 26 3/4"	18 1/2" x 27"	19" x 27 1/2"	20" x 28 1/2"
SD .	17"x 30"	14 3/8" x 27"	4 3/8"	13 1/4" x 25 3/8"	3	16" x 28 1/2"	16 1/2" x 29"	16 3/4" x 29 1/4"	17 1/2" x 30"	17 3/4" x 30 1/4"	18 1/4" x 30 3/4"	18 1/2" x 31"	19" x 31 1/2"	20" x 32 1/2"
SD .	17"x 36"	14 3/8" x 33"	4 3/8"	13 1/4" x 31 3/8"	4	16" x 34 1/2"	16 1/2" x 35"	16 3/4" x 35 1/4"	17 1/2" x 36"	17 3/4" x 36 1/4"	18 1/4" x 36 3/4"	18 1/2" x 37"	19" x 37 1/2"	20" x 38 1/2"
SD .	20"x 26"	17" x 23"	4 3/8"	15 7/8" x 21 3/8"	3	18 5/8" x 24 1/2"	19 1/8" x 25"	19 3/8" x 25 1/4"	20 1/8" x 26"	20 3/8" x 26 1/4"	20 7/8" x 26 3/4"	21 1/8" x 27"	21 5/8" x 27 1/2"	22 5/8" x 28 1/2"
SD	24"x 30"	21" x 27"	4 3/8"	19 7/8" x 25 3/8"	3	22 5/8" x 28 1/2"	23 1/8" x 29"	23 3/8" x 29 1/4"	24 1/8" x 30"	24 3/8" x 30 1/4"	24 7/8" x 30 3/4"	25 1/8" x 31"	25 5/8" x 31 1/2"	26 5/8" x 32 1/2"
SD	24"x 36"	21" x 33"	4 3/8"	19 7/8" x 31 3/8"	4	22 5/8" x 34 1/2"	23 1/8" x 35"	23 3/8" x 35 1/4"	24 1/8" x 36"	24 3/8" x 36 1/4"	24 7/8" x 36 3/4"	25 1/8" x 37"	25 5/8" x 37 1/2"	26 5/8" x 38 1/2"
Glider Door w/ Plain Mirror														
GD .	27"x 21"	24" x 18"	4 3/8"	2@12 3/16" x 16 3/4"	2	25 7/8" x 19 1/2"	26 3/8" x 20"	26 5/8" x 20 1/4"	27 3/8" x 21"	27 5/8" x 21 1/4"	28 1/8" x 21 3/4"	28 3/8" x 22"	28 7/8" x 22 1/2"	29 7/8" x 23 1/2"
GD .	33"x 23"	30" x 20"	4 3/8"	2@15 3/16" x 18 3/4"	2	31 7/8" x 21 1/2"	32 3/8" x 22"	32 5/8" x 22 1/4"	33 3/8" x 23"	33 5/8" x 23 1/4"	34 1/8" x 23 3/4"	34 3/8" x 24"	34 7/8" x 24 1/2"	35 7/8" x 25 1/2"
Double Door "Retro-Fit" Cabinet For Slider Door Replacement w/ 3/4" Perimeter Bevel														
DD .	27"x 21"	24" x 18"	4 3/8"	2@11 3/8" x 16 3/8"	2	25 3/8" x 19 1/2"	26 1/8" x 20"	26 3/8" x 20 1/4"	27 1/8" x 21"	27 3/8" x 21 1/4"	27 7/8" x 21 1/2"	28 1/8" x 21 3/4"	28 5/8" x 22 1/4"	29 5/8" x 23 1/4"
DD .	33"x 23"	30" x 20"	4 3/8"	2@14 3/8" x 18 1/2"	2	31 3/8" x 20 1/16"	32 1/8" x 21 3/16"	32 3/8" x 21 7/16"	33 1/8" x 22 3/16"	33 3/8" x 22 7/16"	33 5/8" x 22 11/16"	33 7/8" x 22 15/16"	34 3/8" x 23 7/16"	35 3/8" x 24 7/16"
Double Door w/ 3/4" Perimeter Bevel Mirror														
DD	24"x 30"	21" x 27"	4 3/8"	2@9 7/8" x 25 3/8"	6	22 5/8" x 28 1/2"	23 1/8" x 29"	23 3/8" x 29 1/4"	24 1/8" x 30"	24 3/8" x 30 1/4"	24 7/8" x 30 3/4"	25 1/8" x 31"	25 5/8" x 31 1/2"	26 5/8" x 32 1/2"
DD	31"x 36"	28" x 33"	4 3/8"	2@13 1/4" x 31 3/8"	8	29 3/8" x 34 1/2"	29 7/8" x 35"	30 1/8" x 35 1/4"	30 7/8" x 36"	31 1/8" x 36 1/4"	31 5/8" x 36 3/4"	31 7/8" x 37"	32 3/8" x 37 1/2"	33 3/8" x 38 1/2"
Triple Door w/ 3/4" Perimeter Bevel Mirror														
TD	34"x 30"	31" x 27"	4 3/8"	3@ 9 7/8" x 25 3/8"	9	32 5/8" x 28 1/2"	33 1/8" x 29"	33 3/8" x 29 1/4"	34 1/8" x 30"	34 3/8" x 30 1/4"	34 7/8" x 30 3/4"	35 1/8" x 31"	35 5/8" x 31 1/2"	36 5/8" x 32 1/2"
TD	38"x 30"	34 1/2" x 27"	4 3/8"	2@ 9 7/8" x 25 3/8" 1@ 13 1/4" x 25 3/8"(M)	9	36" x 28 1/2"	36 1/2" x 29"	36 3/4" x 29 1/4"	37 1/2" x 30"	37 3/4" x 30 1/4"	38 1/4" x 30 3/4"	38 1/2" x 31"	39" x 31 1/2"	40" x 32 1/2"
TD	44"x 30"	41 1/4" x 27"	4 3/8"	3@ 13 1/4" x 25 3/8"	9	42 3/4" x 28 1/2"	43 1/4" x 29"	43 1/2" x 29 1/4"	44 1/4" x 30"	44 1/2" x 30 1/4"	45" x 30 3/4"	45 1/4" x 31"	45 3/4" x 31 1/2"	46 3/4" x 32 1/2"
TD	47"x 36"	43 3/4" x 33"	4 3/8"	2@ 13 1/4" x 31 3/8" 1@ 15 7/8" x 31 3/8"(M)	12	45 3/8" x 34 1/2"	45 7/8" x 35"	46 1/8" x 35 1/4"	46 7/8" x 36"	47 1/8" x 36 1/4"	47 5/8" x 36 3/4"	47 7/8" x 37"	48 3/8" x 37 1/2"	49 3/8" x 38 1/2"
Four Door w/ 3/4" Perimeter Bevel Mirror														
FD	58"x 30"	54 3/4" x 27"	4 3/8"	4@13 1/4" x 25 3/8"	12	56 1/4" x 28 1/2"	56 3/4" x 29"	57" x 29 1/4"	57 3/4" x 30"	58" x 30 1/4"	58 1/2" x 30 3/4"	58 3/4" x 31"	59 1/4" x 31 1/2"	60 1/4" x 32 1/2"
FD	63"x 36"	59 3/4" x 33"	4 3/8"	2@ 13 1/4" x 31 3/8" 2@ 15 7/8" x 31 3/8"(M)	16	61 1/4" x 34 1/2"	61 3/4" x 35"	62" x 35 1/4"	62 3/4" x 36"	63" x 36 1/4"	63 1/2" x 36 3/4"	63 3/4" x 37 1/2"	64 1/4" x 37 1/2"	65 1/4" x 38 1/2"
Light Bar														
LT	___" x ___"					6" Height	6 1/2" Height	6 3/4" Height	7 1/2" Height	7 3/4" Height	8 1/4" Height	8 1/2" Height	9" Height	10" Height
LC	___" x ___"					6" Height	6 1/2" Height	6 3/4" Height	7 1/2" Height	7 3/4" Height	8 1/4" Height	8 1/2" Height	9" Height	10" Height
Side Sconces														
ST .	___" x ___"					6" x 12"	6 1/2" x 12 1/2"	6 3/4" x 12 3/4"	7 1/2" x 13 1/2"	7 3/4" x 13 3/4"	8 1/4" x 14 1/4"	8 1/2" x 14 1/2"	9" x 15"	10" x 16"
SC .	___" x ___"					6" x 12"	6 1/2" x 12 1/2"	6 3/4" x 12 3/4"	7 1/2" x 13 1/2"	7 3/4" x 13 3/4"	8 1/4" x 14 1/4"	8 1/2" x 14 1/2"	9" x 15"	10" x 16"

* Can be shipped UPS or FedEx Ground w/foam packing



Outside Dimensions by Frame Style Size

Specifications

Specifications

Product Code	Approx. Overall Dimen. (WxH)	Recessed Rough Wall Opening	Depth Of Cabinet	Mirror Door Sizes (M=Middle Door)	Number Of Glass Shelves	Group 1	Group 2	Group 3	Group 4	Group 5	Group 6	Group 7	Group 8	Group 9
						1 1/4" Frame	1 1/2" Frame	1 5/8" Frame	2" Frame	2 1/8" Frame	2 3/8" Frame	2 1/2" Frame	2 3/4" Frame	3 1/4" Frame
						Brushed Satin (SAT) Soho (SOH)	Aristocrat (ARS) Colorgrain (COL)	Arlington (ARL) Majestic (MAJ) Rustic Wood (RUS) Tuscany (TUS) Valencia (VAL)	Jewel Cut Bevel (JCB) Meridian (MER) Parliament (PAL) Roman (ROM) Tribeca (TRI)	Chateau (CHA) Parisian (PAR)	Sienna (SIE)	Versailles (VER)	Elegance (ELG)	Regal (REG)
Framed Mirror														
FM .	16"x 22"	MIRROR SIZE #1				18 1/4" x 24 1/4"	18 3/4" x 24 3/4"	19" x 25"	19 3/4" x 25 3/4"	20" x 26"	20 1/2" x 26 1/2"	20 3/4" x 26 3/4"	21 1/4" x 27 1/4"	22 1/4" x 28 1/4"
FM .	20"x 26"	MIRROR SIZE #2				22 1/4" x 26 1/4"	22 3/4" x 28 3/4"	23" x 29"	23 3/4" x 29 3/4"	24" x 30"	24 1/2" x 30 1/2"	24 3/4" x 30 3/4"	25 1/4" x 31 1/4"	26 1/4" x 32 1/4"
FM .	20"x 30"	MIRROR SIZE #3				22 1/4" x 32 1/4"	22 3/4" x 32 3/4"	23" x 33"	23 3/4" x 33 3/4"	24" x 34"	24 1/2" x 34 1/2"	24 3/4" x 34 3/4"	25 1/4" x 35 1/4"	26 1/4" x 36 1/4"
FM .	24"x 30"	MIRROR SIZE #4				26 1/4" x 32 1/4"	26 3/4" x 32 3/4"	27" x 33"	27 3/4" x 33 3/4"	28" x 34"	28 1/2" x 34 1/2"	28 3/4" x 34 3/4"	29 1/4" x 35 1/4"	30 1/4" x 36 1/4"
FM*	24"x 36"	MIRROR SIZE #5				26 1/4" x 38 1/4"	26 3/4" x 38 3/4"	27" x 39"	27 3/4" x 39 3/4"	28" x 40"	28 1/2" x 40 1/2"	28 3/4" x 40 3/4"	29 1/4" x 41 1/4"	30 1/4" x 42 1/4"
Integral Lighted Bath Cabinetry														
Single Door (SD-LC/LT) 3/4" Front Bevel Mirror Is Standard (Must specify if door is hinged left or right for Single Door)														
SD-LC/LT .	17"x 30"	14 3/8" x 27 1/4"	4 3/8"	13 1/4" x 21 3/8"	3	16" x 28 3/4"	16 1/2" x 29 1/4"	16 3/4" x 29 1/2"	17 1/2" x 30 1/4"	17 3/4" x 30 1/2"	18 1/4" x 31"	18 1/2" x 31 1/4"	19" x 31 3/4"	20" x 32 3/4"
SD-LC/LT .	17"x 34"	14 3/8" x 31 1/4"	4 3/8"	13 1/4" x 25 3/8"	3	16" x 32 3/4"	16 1/2" x 33 1/4"	16 3/4" x 33 1/2"	17 1/2" x 34 1/4"	17 3/4" x 34 1/2"	18 1/4" x 35"	18 1/2" x 35 1/4"	19" x 35 3/4"	20" x 36 3/4"
SD-LC/LT .	17"x 40"	14 3/8" x 37 1/4"	4 3/8"	13 1/4" x 31 3/8"	4	16" x 38 3/4"	16 1/2" x 39 1/4"	16 3/4" x 39 1/2"	17 1/2" x 40 1/4"	17 3/4" x 40 1/2"	18 1/4" x 41"	18 1/2" x 41 1/4"	19" x 41 3/4"	20" x 42 3/4"
SD-LC/LT .	20"x 30"	17" x 27 1/4"	4 3/8"	15 7/8" x 21 3/8"	3	18 5/8" x 28 3/4"	19 1/8" x 29 1/4"	19 3/8" x 29 1/2"	20 1/8" x 30 1/4"	20 3/8" x 30 1/2"	20 7/8" x 31"	21 1/8" x 31 1/4"	21 5/8" x 31 3/4"	22 5/8" x 32 3/4"
SD-LC/LT	24"x 34"	21" x 31 1/4"	4 3/8"	19 7/8" x 25 3/8"	3	22 5/8" x 32 3/4"	23 1/8" x 33 1/4"	23 3/8" x 33 1/2"	24 1/8" x 34 1/4"	24 3/8" x 34 1/2"	24 7/8" x 35"	25 1/8" x 35 1/4"	25 5/8" x 35 3/4"	26 5/8" x 36 3/4"
SD-LC/LT	24"x 40"	21" x 37 1/4"	4 3/8"	19 7/8" x 31 3/8"	4	22 5/8" x 38 3/4"	23 1/8" x 39 1/4"	23 3/8" x 39 1/2"	24 1/8" x 40 1/4"	24 3/8" x 40 1/2"	24 7/8" x 41"	25 1/8" x 41 1/4"	25 5/8" x 41 3/4"	26 5/8" x 42 3/4"
Double Door (DD-LC/LT) 3/4" Front Perimeter Bevel Mirror Is Standard														
DD-LC/LT	24"x 34"	21" x 31 1/4"	4 3/8"	2@9 7/8" x 25 3/8"	6	22 5/8" x 32 3/4"	23 1/8" x 33 1/4"	23 3/8" x 33 1/2"	24 1/8" x 34 1/4"	24 3/8" x 34 1/2"	24 7/8" x 35"	25 1/8" x 35 1/4"	25 5/8" x 35 3/4"	26 5/8" x 36 3/4"
DD-LC/LT	31"x 40"	28" x 37 1/4"	4 3/8"	2@13 1/4" x 31 3/8"	8	29 3/8" x 38 3/4"	29 7/8" x 39 1/4"	30 1/8" x 39 1/2"	30 7/8" x 40 1/4"	31 1/8" x 40 1/2"	31 5/8" x 41"	31 7/8" x 41 1/4"	32 3/8" x 41 3/4"	33 3/8" x 42 3/4"
Triple Door (TD-LC/LT) 3/4" Front Perimeter Bevel Mirror Is Standard														
TD-LC/LT	34"x 34"	31" x 31 1/4"	4 3/8"	3@ 9 7/8" x 25 3/8"	9	32 5/8" x 32 3/4"	33 1/8" x 33 1/4"	33 3/8" x 33 1/2"	34 1/8" x 34 1/4"	34 3/8" x 34 1/2"	34 7/8" x 35"	35 1/8" x 35 1/4"	35 5/8" x 35 3/4"	36 5/8" x 36 3/4"
TD-LC/LT	38"x 34"	34 1/2" x 31 1/4"	4 3/8"	2@ 9 7/8" x 25 3/8" 1@ 13 1/4" x 25 3/8"(M)	9	36" x 32 3/4"	36 1/2" x 33 1/4"	36 3/4" x 33 1/2"	37 1/2" x 34 1/4"	37 3/4" x 34 1/2"	38 1/4" x 35"	38 1/2" x 35 1/4"	39" x 35 3/4"	40" x 36 3/4"
TD-LC/LT	44"x 34"	41 1/4" x 31 1/4"	4 3/8"	3@ 13 1/4" x 25 3/8" 2@ 13 1/4" x 31 3/8"	9	42 3/4" x 32 3/4"	43 1/4" x 33 1/4"	43 1/2" x 33 1/2"	44 1/4" x 34 1/4"	44 1/2" x 34 1/2"	45" x 35"	45 1/4" x 35 1/4"	45 3/4" x 35 3/4"	46 3/4" x 36 3/4"
TD-LC/LT	47"x 40"	43 3/4" x 37 1/4"	4 3/8"	1@ 15 7/8" x 31 3/8"(M)	12	45 3/8" x 38 3/4"	45 7/8" x 39 1/4"	46 1/8" x 39 1/2"	46 7/8" x 40 1/4"	47 1/8" x 40 1/2"	47 5/8" x 41"	47 7/8" x 41 1/4"	48 3/8" x 41 3/4"	49 3/8" x 42 3/4"

* Can be shipped UPS or FedEx Ground w/foam packing

Answers to Frequently Asked Questions:

All Signature Cabinets are constructed of rust proof satin gray anodized aluminum

“SD” - Single Door Signature Cabinet

- Cabinet body measures 4- $\frac{3}{8}$ " deep. When recessing cabinet, less than 4" goes into wall. The frame will be completely flush to the wall.
- Door has a pivot hinge which pivots into the cabinet body, and is securely screwed into the door for ease of removal and remounting of the door.
- 3/8" high polished glass shelves are fully adjustable.
- Frame is independent of door and is mounted to the perimeter of cabinet body. Outside dimensions will vary by frame style size (see specifications). [page 30](#)
- Single Door cabinets come standard with front 3/4" bevel mirror door. Plain mirror is available upon request
- 3 Mirror design (front bevel mirror, mirror behind door, and inside mirrored back).
- Cabinet can be hinged on either side by rotating cabinet 180° and then repositioning the door pull.
- Optional Mirrored Sides for Surface Mounting is available - option code "MS".
- Optional 5x Magnifying Mirror is available - option code "MM".

“GD” - Gliding Door Signature Cabinet

- Cabinet body measures 4- $\frac{3}{8}$ " deep. When recessing cabinet, less than 4" goes into wall. The frame will be completely flush to the wall.
- Finger grips to open doors are ground into mirror.
- Ball bearing wheels in sliding tracks for ease of opening and closing doors.
- 3/8" high polished glass shelves are fully adjustable.
- Frame is independent of door and is mounted to the perimeter of cabinet body. Outside dimensions will vary by frame style size (see specifications). [page 30](#)
- Optional Mirrored Sides for Surface Mounting is available - option code "MS".
- Optional 5x Magnifying Mirror is available - option code "MM".

“DD” - Double Door “Retro” Signature Cabinet

- Cabinet body measures 4- $\frac{3}{8}$ " deep. When recessing cabinet, less than 4" goes into wall. The frame will be completely flush to the wall.
- Doors have pivot hinges that pivot into the cabinet body, and is securely screwed into the doors for ease of removal and remounting of the doors.
- 3/8" high polished glass shelves are fully adjustable.
- Frame is independent of doors and is mounted to the perimeter of cabinet body. Outside dimensions will vary by frame style size (see specifications). [page 30](#)
- Double Door cabinets come standard with front 3/4" perimeter bevel mirror doors. Plain mirror is available upon request
- 3 Mirror design (front bevel mirror, mirror behind door, and inside mirrored back).
- Optional Mirrored Sides for Surface Mounting is available - option code "MS".
- Optional 5x Magnifying Mirror is available - option code "MM".

“DD” - Double Door / “TD” - Triple Door / “FD” - Four Door Signature Cabinet

- Cabinet body measures 4- $\frac{3}{8}$ " deep. When recessing cabinet, less than 4" goes into wall. The frame will be completely flush to the wall.
- Doors have pivot hinges that pivot into the cabinet body, and is securely screwed into the doors for ease of removal and remounting of the doors.
- 3/8" high polished glass shelves are fully adjustable in the; 2 for DD / 3 for TD / 4 for FD separate compartments.
- Frame is independent of doors and is mounted to the perimeter of cabinet body. Outside dimensions will vary by frame style size (see specifications). [page 30](#)
- Double Door, Triple Door, Four Door cabinets come standard with front 3/4" perimeter bevel mirror doors. Plain mirror is available upon request
- 3 Mirror design (front bevel mirror, mirror behind door, and inside mirrored back).
- Optional Mirrored Sides for Surface Mounting is available - option code "MS".
- Optional 5x Magnifying Mirror is available - option code "MM".

“LT/LC” - Light Bar & “ST/SC” - Side Sconcé

- Frame style will add to the height of light (see specifications). [page 30](#)
- LT, Traditional Light Bars need a total of 9" in height clearance as arched arms extend above most frame styles, on top.
- All lights have 60 watt per socket capabilities.
- Backplates and Hardware are available in Polished Brass (BR), Polished Chrome (CR) or Satin Nickel (SN) finishes. You must specify when ordering.
- Optional Surface Mount is available to match surface mounted cabinets - option code "SM" (for light bars only).

Important Special Notes:

1. Recessed Lights do not go into wall. They match the depth of the frame to match a recessed cabinet or framed mirror. There is no cut out or rough wall opening needed, they mount flush to the wall. They are to match a recessed cabinet.
2. Surface Mounted Lights are mounted to the wall and extend approximately 4-3/8" from the wall to match a surface mounted cabinet. There is no cut out or rough wall opening needed.

“FM” - Framed Mirrors

- 5 standard mirror sizes available.
- Frame style is added to the mirror size, therefore, outside dimensions will vary by frame style (see specifications sheet). [page 32](#)
- Plain Mirror or Optional Beveled Mirror is available - option code "BV".
- Custom sizes available (upon request).

Properties of Afina Signature Cabinets:

- Rust proof gray satin anodized aluminum construction
- Pivot door hinge system (no visible hinge)
- 3 Mirror design (front bevel mirror, mirror behind door, and mirror behind glass shelves on back wall)
- 3/8" thick high polished adjustable glass shelves
- Recessed frame cabinets are totally flush to wall for a decorative framed mirror look.
- Cabinets can be hinged left or right by rotating cabinet 180°, then repositioning the door pull
- Available in over 25 standard sizes
- Available in over 50 frame styles & finishes
- Optional surface mount kits with mirrored sides are available for all Signature Cabinets
- Optional 8"-5x magnifying mirror is available for all Signature Cabinets

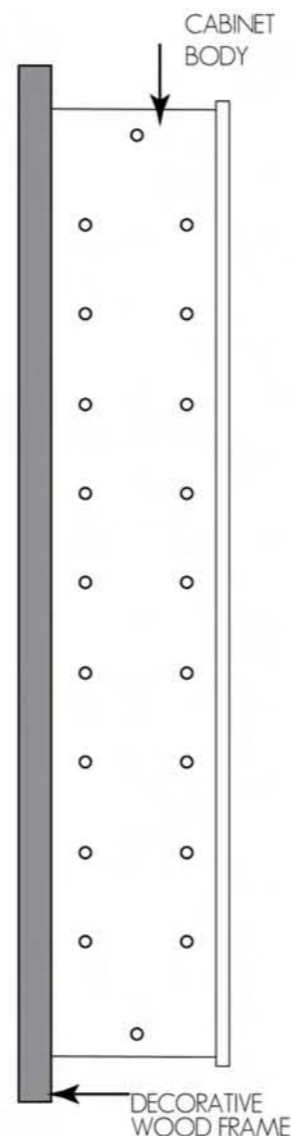

*See [page 34](#) for more detailed information about our Signature Collection cabinets